



The Tree Tops, 2 Warren Lane, Lickey, B45 8ER

£595,000

**arden**
ESTATE AGENTS

It's who
you move
with.

The Tree Tops, 2 Warren Lane, Lickey, B45 8ER

A SUPERB DEVELOPMENT OPPORTUNITY WITH OUTLINE
PLANNING CONSENT FOR A "GRAND DESIGN" NEW BUILD HOME









Rose Hill 2

Lickey

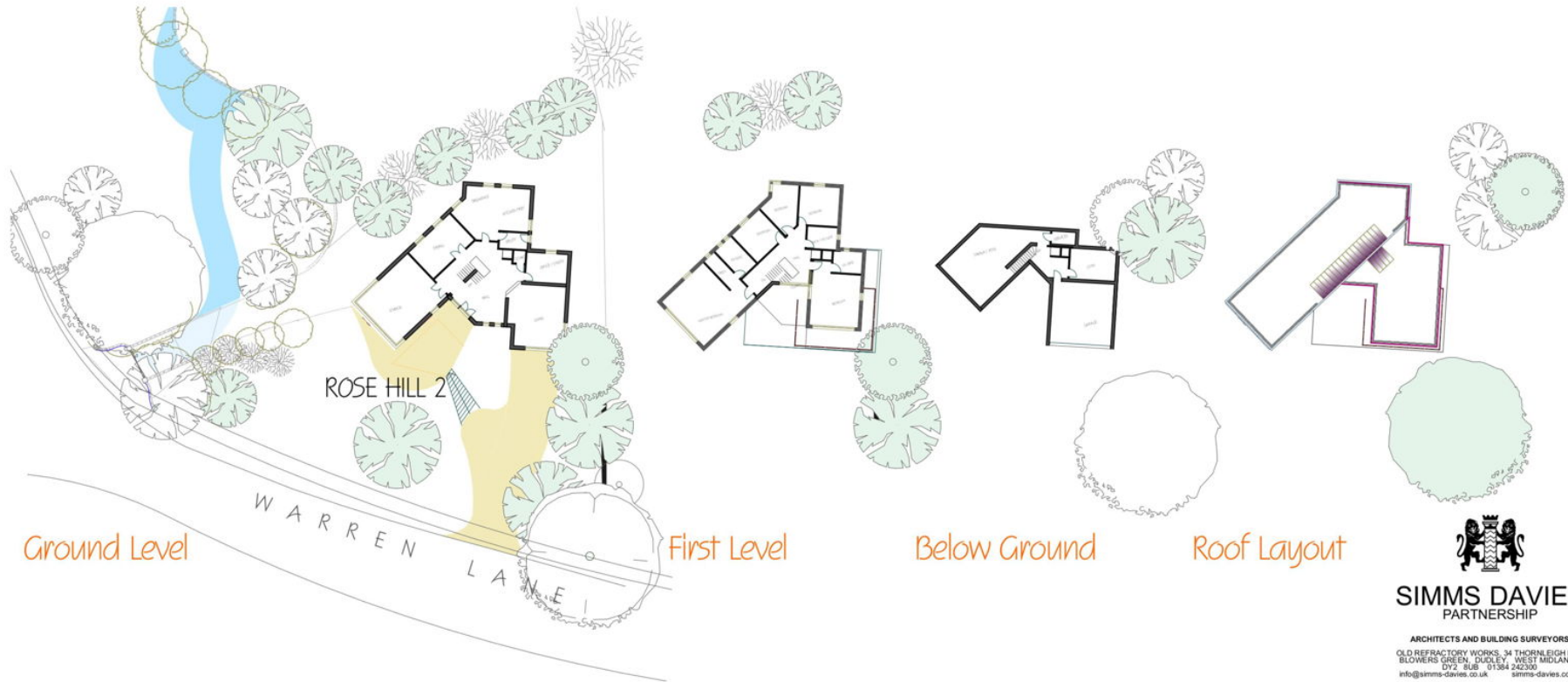

Ground Level

ROSE HILL 2

WARREN
LANE

First Level

Below Ground

Roof Layout

0 1 2 3 4 5m 10m 20m



These drawings are the property of Simms Davies Partnership. Copyright is reserved by Simms Davies Partnership. No part of these drawings may be reproduced, stored in a retrieval system, or transmitted in any form or by any means, electronic, mechanical, photocopying, recording, or by any information storage and retrieval system, without the prior written permission of Simms Davies Partnership. All rights reserved.



SIMMS DAVIES PARTNERSHIP

ARCHITECTS AND BUILDING SURVEYORS
OLD REFRACTORY WORKS, 34 THORNLEIGH EST
BLOWERS GREEN, DUDLEY, WEST MIDLANDS
DY2 2UB 01564 242200
info@simms-davies.co.uk simms-davies.co.uk

Rose Hill House, Lickey, Worcestershire.	
Rose Hill 2	
Scale 1:100	Orig. No. 4044 / 52A
Drawn	
Revisions	No Date
No. Date	Drawn by Date

For more information on this house or to arrange a viewing please call the office on:
0121 447 8300

Alternatively, you can scan the QR to view all of the details of this property online.

